

Congratulations on your purchase of a modern **AURATON H-1** window handle, built on the basis of an advanced microprocessor, equipped with position sensors and a radio transmitter.

Content of package



Window handle
AURATON T-1



screws

Description of device

The **AURATON H-1** window handle is an optional element of the **AURATON** house automation system. The handle is equipped with a position sensors and a transmitter. As a result, the installed handle transfers information on the window's position to the **AURATON RTH** receiver (or the **RTA** receiver - alarm systems or the **RTF** receiver - fire protection systems) that shall make the decision about e.g. turning off the heating device in the case of opening the window or decreasing the temperature by 3°C when window is left ajar, which allows to save energy.

- The handle distinguishes 4 window positions:
 - open,
 - closed,
 - ajar,
 - unsealed (micro ventilation).
- One **RTH**, **RTA** or **RTF** receiver supports maximum **25 handles**.
- The **AURATON H-1** window handles are offered in 4 colours:
 - white,
 - brown,
 - silver,
 - dark silver.



The **AURATON H-1** handle is equipped with factory mounted lithium battery from a Swiss company from the **SWATCH** group. Expected battery life is up to **20 years**.

NOTE: Non-removable battery.

Associating H-1 handle with receiver

In order for the **AURATON H-1** handle to operate correctly, one should "associate" it with the **RTH**, **RTA** or **RTF** receiver.

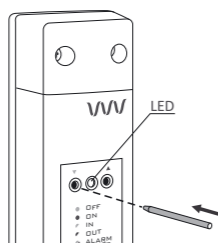

1. Associating the **H-1** handle with the receiver is initiated by pressing the left association button (green triangle - ▼) on the receiver and pressing it for at least 2 seconds. until the LED diode starts flashing with a green light, then we release the button..

Note: The receiver waits for the association for 120 seconds. After this time it will automatically return to normal operation.

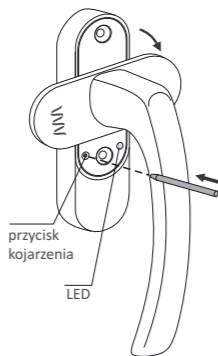

2. When the LED diode of the receiver flashes with a green light "the association button" should be pressed on the **H-1** handle (located under the cover) and held pressed for at least 2 seconds. When the LED diode on the handle starts flashing with a red light we release the button.

3. Correct completion of association is signaled by the stop of flashing with a green light of the LED diode on the receiver and the receiver going into normal operation.

In the case of an error during the association, steps 1 and 2 should be repeated. During subsequent errors all devices should be signed out by **RESETTING** the receiver (see chapter "**RESETTING - Signing out all equipment assigned to the receiver**") and try to associate the device again.

NOTE: Once the device is added it cannot be again associated with the same receiver, since it is already saved in the memory of the receiver.

Signing out H-1 handle from receiver

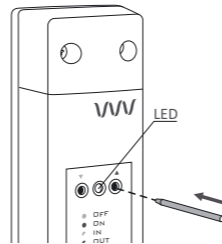

1. Signing out the **H-1** handle from the receiver is initiated by pressing the right signing out button (red triangle - ▲) on the receiver and pressing it for at least 2 seconds until the LED diode starts flashing with a red light, then we release the button.

Note: The receiver waits for signing out the device for 120 seconds. After this time it will automatically return to normal operation.

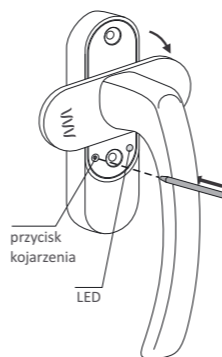

2. When the LED diode of the receiver flashes with a red light "the association button" should be pressed on the **H-1** handle (located under the cover) and held pressed for at least 2 seconds. When the LED diode on the handle starts flashing with a red light we release the button.

3. The correct completion of signing out is signaled by the stop of flashing with a red light of the LED diode on the receiver and the receiver going into normal operation.

In the case of an error, steps 1 and 2 should be repeated.

RESETTING - Signing out all devices assigned to receiver

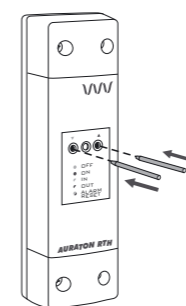

In order to sign out all devices associated with the receiver press and hold at the same time both association and sign out buttons (▼ and ▲) for at least 5 seconds until signalling of the LED diode changes to alternate flashing in the green and red colours. Then release both buttons.

The correct completion of signing out of all devices is signaled after about 2 sec by a change in signalling to green and then its fading.

Method of assembling H-1 window handle

The **AURATON H-1** window handle is fastened to the window frame on two bolts just as a standard window handle. Spacing of openings for fixing screws and the length of a bolt is standard for most window frames.



Turn the "screw shield" on the **H-1** handle.

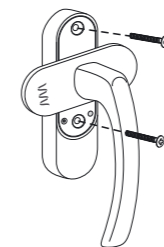

With the use of the attached screws, screw the handle to the window frame.



After fixing the handle, put the screw cover into its position.

Note: before assembling the handle preferably first associate it with the receiver.



Cooperation of AURATON H-1 handle with heating system

AURATON H-1 window handle with **AURATON T-1 RTH** and/or **T-2**



AURATON H-1
Window handle



AURATON RTH
Receiver to be purchased separately in the set with T-1

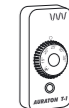

AURATON T-1
Wireless temperature regulator to be purchased separately in the set with RTH

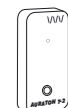

AURATON T-2
Wireless thermometer to be purchased separately

When we associate at least one **AURATON H-1** handle with the **AURATON RTH** receiver, with which temperature regulator and/or **T-2** thermometer were associated then controlling the transmitter will proceed as follows:

- **Window closed or unsealed (micro ventilation)** – When all windows with **H-1** handles are closed or unsealed then the transmitter executes the setting from the associated **AURATON T-1** controller and/or **AURATON T-2** thermometer.
- **Window ajar** – when we slightly open at least one window, in the **AURATON RTH** receiver the set temperature of the **T-1** controller will be decreased by 3°C. This state will last until the time of closing or unsealing all windows associated with the RTH receiver.

Example: On the T-1 regulator we have set the temperature of 21°C. After slightly opening the window with an associated H-1 handle the RTH receiver will maintain the temperature of 18°C.

■ **Open window** – When the window with the associated **H-1** handle is open for longer than 30 sec, the transmitter in the **AURATON RTH** receiver will be turned off and the heating device will also turn off. If all assigned windows will be again in the position other than open, the **RTH** receiver will return to normal cooperation with the **T-1** controller and/or **T-2**, thermometer after time not shorter than 90 sec from turning off the transmitter. This is an intentional delay to prevent too rapid changes of heating devices between the ON - OFF position. However, if the temperature in the room falls below 7°C, regardless of the location of windows, the transmitter in the receiver will be activated switching on the heating device to prevent the room from freezing.

■ **Loss of signal** – When the **RTH** receiver loses signal from the associated **H-1** handle or window position sensor (3 subsequent transmission losses), it changes this window's status to closed. After restoring the transmission, the **H-1** handle or window position sensor is again correctly read by the receiver **RTH**.

Note: One AURATON RTH receiver can operate max. 25 handles.



AURATON H-1 handle cooperation with the air-conditioning system

Window handle **AURATON H-1** with receiver **AURATON RTH**

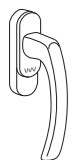

Window handle
AURATON H-1



Receiver
AURATON RTH
(purchased separately)

In order for the **RTH** receiver to be able to control the air-conditioning it cannot be associated with any **T-1** controller or **T-2** thermometer and must be associated with at least one **H-1** handle. Upon fulfillment of the above requirements, the **RTH** receiver automatically goes into the air-conditioning control mode.

■ **Window open or ajar** – If we connect the power supply circuit of the air-conditioning device through the transmitter and open or leave ajar any window with the associated **H-1** handle for longer than 30 sec, the transmitter in the **RTH** receiver will turn off the air-conditioning device.

■ **Window closed or unsealed** – If all windows with the associated **H-1** handle will again be in the position other than open or ajar, the **RTH** receiver after time not shorter than 90 sec from turning off the transmitter shall again activate the transmitter and the air-conditioning device. This is an intentional delay to prevent too rapid changes of air conditioning devices between the ON - OFF position, which can lead to compressor damage.

■ **Loss of signal** – When the **RTH** receiver loses signal from the associated **H-1** handle (3 subsequent transmission losses), it changes this window's status to closed. After restoring the transmission the sensor is again correctly read by the receiver.

NOTE: the association of the RTH receiver with the T-1 controller or T-2 thermometer automatically changes the way the receiver works to controlling the heating device.

Note: One AURATON RTH receiver can operate max. 25 handles.



AURATON H-1 handle cooperation with the alarm system

Window handle **AURATON H-1** with receiver **AURATON RTA**



Window handle
AURATON H-1

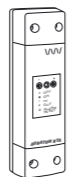

Receiver
AURATON RTA
(purchased separately)

AURATON H-1 wireless handle effectively replaces the reed relay, which requires wire connection with the alarm system for proper operation. Thanks to wireless operation and easy assembly of **H-1** handles we do not need to lay visible cables that reveal the presence of the alarm system.

Operation of **AURATON H-1** handle:

- **Window closed, ajar or unsealed (micro ventilation)** – alarm system is in the stand-by mode.
- **Window open** – alarm system will activate the alarm.

Note: One AURATON RTA receiver can operate max. 25 handles.



AURATON H-1 handle cooperation with the fire protection system

Window handle **AURATON H-1** with receiver **AURATON RTF**



Window handle
AURATON H-1



Receiver
AURATON RTF
(purchased separately)

The **AURATON H-1** handle associated with the **AURATON RTF** receiver connected to the fire protection system.

- **Temperature sensor** – In the **AURATON H-1** handle a temperature sensor has been installed, whose task is to monitor the environment temperature. If the sensor detects that the environment temperature exceeds 57°C or grows faster than 1 °C per 10 seconds (above 30°C), it will activate the fire protection system.

Note: One AURATON RTF receiver can operate max. 25 handles.

Technical data

Radio frequency:	868 MHz
Power supply:	lithium battery (factory built) non-removable battery
Range of operation:	in a typical building, with walls of standard structure - ca. 30m, in an open area - up to 300m

Disposal of device



The devices are marked with a symbol of a crossed out container for waste. According to the European Directive 2002/96/EC and the Act on Electrical and Electronic equipment such marking informs that this equipment, after its period of use cannot be put along with other waste from the household.

The User is obliged to hand it over to an electronic and electrical equipment waste collection point.



www.auraton.pl

AURATON H-1

www.auraton.pl

